

D6-4-980-300

Key features

Visible Light $\lambda = 980\text{nm}$
Output Power = 300mW
Package Type= 9.0mm Φ

Applications

General Purpose Infrared Red Laser Light Source

Electrical and Optical Characteristics at $T_c=25^\circ\text{C}$

Item	Symbols	Min.	Typ.	Max.	Unit	Condition
Optical Output Power	Po	-	300	-	mW	-
Threshold Current	Ith	-	105	140	mA	Po=300mW
Operating Current	Iop	-	530	740	mA	Po=300mW
Differential Efficiency	SE	0.5	0.7	-	mW/mA	Po=300mW
Operating Voltage	Vop	1.2	1.6	2.3	V	Po=300mW
Peak Wavelength	λ_p	970	980	990	nm	Po=300mW
Beam Divergence	$\theta_{//}$	-	7	-	deg	Po=300mW
	θ_{\perp}	28	31	42	deg	Po=300mW

EGISMOS IR Laser Diode

Absolute Maximum Rating at Tc=25°C

Items	Symbols	Values	Unit
Optical Output Power	Po(CW)	300	mW
Laser Diode Reverse Voltage	V	2	V
Operating Temperature	To	-10~+40	°C
Storage Temperature	Ts	-40~+85	°C

Electrical Connection

Package Type

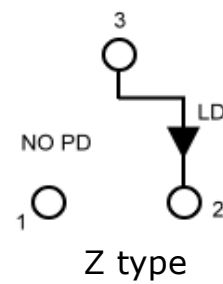
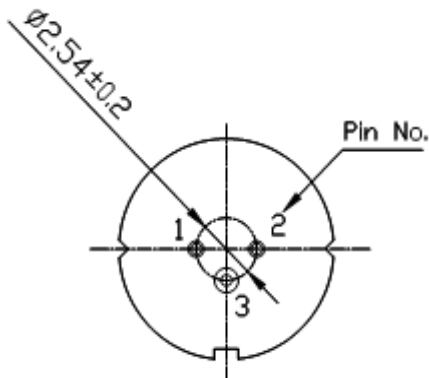

Package Drawing

